

LELAPA LODGE – FACT SHEET

Lelapa Lodge & The Reserve Pg1 | Architectural Layouts Pg2 | Reference Table Pg3

Lelapa Lodge | Tel: +27 (0)18 350 9902 | Email: res@madikwesafarilodge.co.za

About the Lodge

Madikwe Safari Lodge's Lelapa Lodge is ideally located for guests to appreciate the vastness and diversity of Madikwe Game Reserve's land-scapes and wildlife. Lelapa (meaning 'family' in Setswana) welcomes guests of all ages, with family-friendly accommodations and specially-planned children's activities. Each of its 12 luxury Suites has a private lounge, viewing deck, and plunge pool, with the four Family Suites also incorporating a second children's bedroom, stocked with toys and games. While the lodge epitomises contemporary African design, its atmosphere is luxuriously laid-back.

Lodge Features

- **Main lodge bar, guest lounge, dining area, boma, and viewing/dining deck**
- **Kosher dining offering to ensure our Jewish guests can enjoy every treat a stay here has to offer**
- **Serviced guest pool and loungers, positioned just up a waterhole for an incredible 'poolside safari'**
- **In-room spa and beauty treatments at the hands of expert therapists**
- **Complimentary Wi-Fi – but we recommend reconnecting with each other**
- **Madikwe Safari Lodge Gallery, curating rare and beautiful items for guests to take home and treasure a piece of South Africa**
- **Madikwe Safari Lodge Kids' Adventure Safari Club – stays, meals and activities are all taken care of for the best time they'll have in the bush!**
- **Eco House kids' entertainment and education area where kids discover through having fun**

Location

Lelapa Lodge, Madikwe Safari Lodge is located in the central-eastern region of Madikwe Game Reserve. The area surrounding the lodge is well known for its rich biodiversity and provides some of the best game-viewing opportunities on the reserve.

GPS co-ordinates: should not be followed as these may get guests lost and most recommended routes are not navigable by normal vehicle.

Weather

Average maximum temperatures range from 23°C/73°F in July to 40°C/104°F in January, with the lowest average minimum occurring in July at 2°C/36°F · The region is semi-arid, with an average annual rainfall of 500mm (20in), occurring mostly during the summer months (December – February) · Rain is usually in the form of thundershowers, where a downpour is experienced, very seldom lasting longer than a few hours

Best Time to Travel

A year-round safari destination · The animals in Madikwe Game Reserve are non-migratory, and variation in the safari experience is season rather than location related · The best period for birdwatching is from October to April

Health Info: Malaria

Lelapa Lodge, Madikwe Safari Lodge is situated in a region of South Africa that is not inhabited by the malaria-carrying mosquito (Anopheles) and is therefore classified MALARIA FREE.

Lelapa Lodge Layout

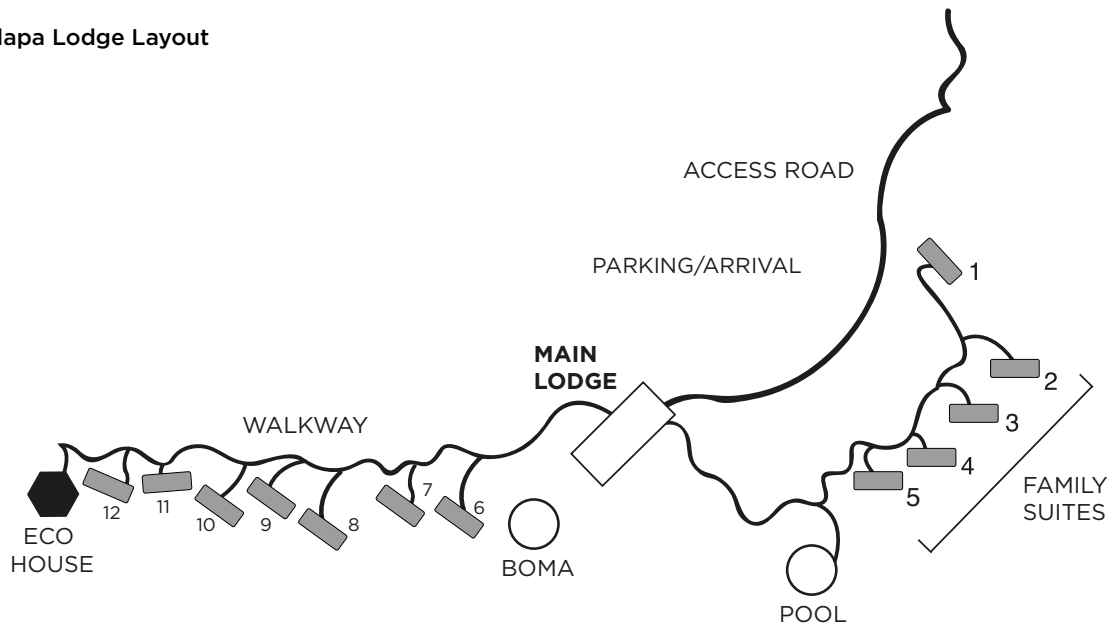

Lelapa Lodge Suite Layout

Interior - 50m² | 540ft²
 Exterior - 50m² | 540ft²
 Total - 100m² | 1 080ft²

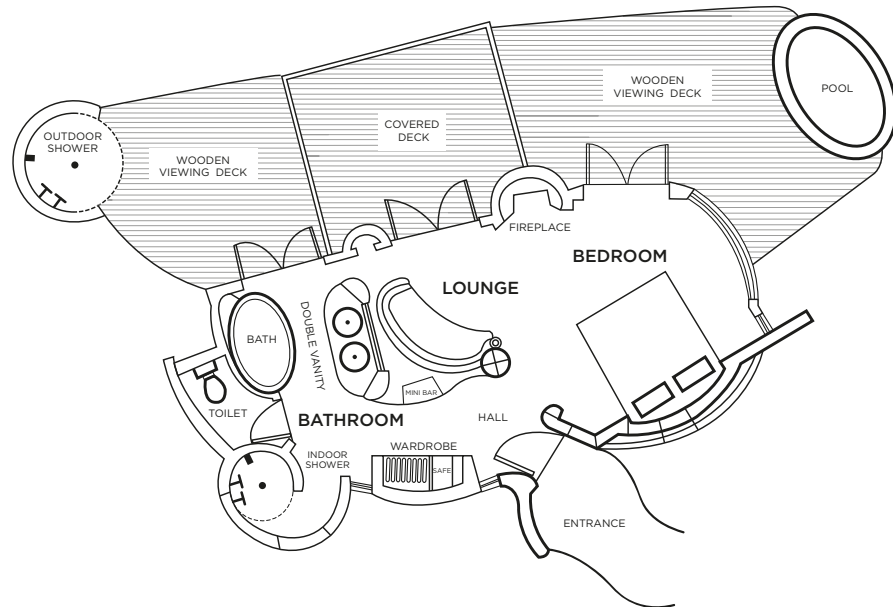

Lelapa Lodge Family Suite Layout

Interior - 50m² | 540ft²
 Exterior - 50m² | 540ft²
 Total - 100m² | 1 080ft²

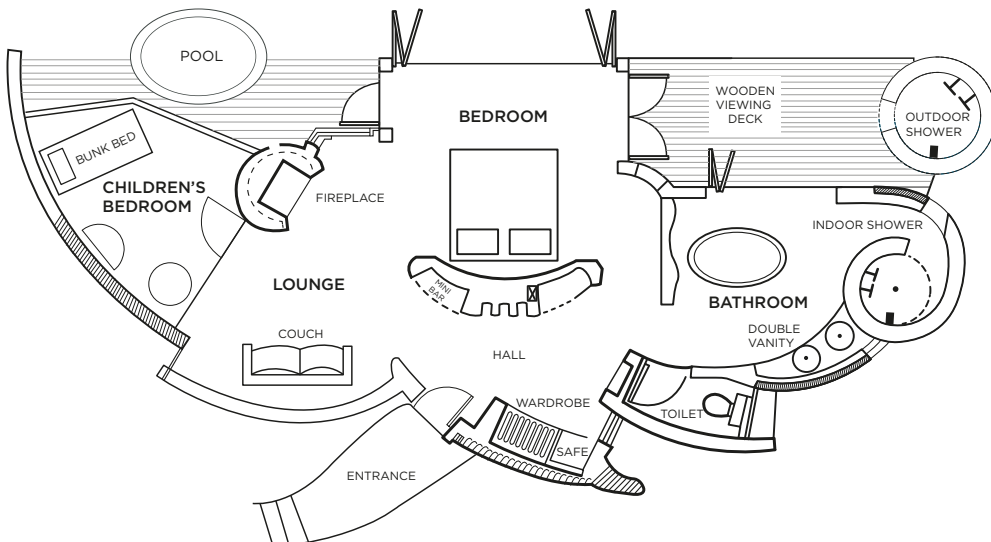

Reference Table - Lelapa Lodge

Reference	Lelapa Lodge
Suites	12 Suites (incl 4 Family Suites)
Size of suites	Suites: 100m ² /1 080ft ²
Guests	24
Children	Yes (all ages)
Children's rate	<5 (free) 6 to 15 (50% of adult rate)
Children on safari	Private and family game drive (all ages) Twice-daily game drive (>6)
Children activities	Yes
Childminding	Yes (additional cost)
Triple rooms (sleeper couch)	5
Single traveller supplement	Yes (50% supplement)
Double bed convertible to twin	Yes
Central guest pool	Yes
Private plunge pool	Yes
Air conditioning	Yes
Fireplace	Yes
Room fans	Yes
Mosquito nets	Yes
Outdoor shower	Yes
Indoor showers	Yes
Separate WC	Yes
Free Wi-Fi	Yes
Satellite television	Yes (guest area)
In-room telephone	Yes (direct dial)
Mobile coverage	Average: 60% (MTN/Vodacom)
In-room safe	Yes
Minibar	Yes
Hairdryer	Yes
Laundry	Yes (additional cost)
Conference facilities	Yes (but no dedicated room)
Spa facilities	In-room treatments (additional cost)
Gym facilities	Yes - 'Gym in a Basket' (with a yoga mat, weights, resistance bands, and jump rope)
Suitable for disabled guests	Yes (with assistance)
Distance between rooms	10-15m/33-49ft
Airstrip	Yes (10 minutes away) 24°44'0"S 26°24'25"E
Helipad	Yes (24°43'11.8"S 26°23'4.2"E)
Guests per open safari vehicle	6
Private open safari vehicle	Yes (additional cost, subject to availability)
Languages of field rangers	English, Afrikaans
Gratuuity recommendation	ZAR600* per guest per day *Specific allocations clarified on request
Kosher dining	Yes (with prior notice, at an additional cost)
Power	220V AC
Credit cards	Mastercard, Visa, Amex
Cheques	Not accepted