

## LODGE – FACT SHEET

Madikwe & The Reserve Pg1 | Architectural Layouts Pg2 | Reference Table Pg5

Lelapa Lodge, Kopano Lodge, Dithaba Lodge & Elela Villa | Tel: +27 (0)18 350 9902 | Email: [res@madikwesafarilodge.co.za](mailto:res@madikwesafarilodge.co.za)

[www.madikwesafarilodge.co.za](http://www.madikwesafarilodge.co.za)

### Unique Selling Points

Situated in Madikwe Game Reserve – one of South Africa's largest wildlife sanctuaries, covering 76 000ha (188 000ac), which is also malaria-free

- Home to the Big Five, endangered African wild dog, and 60 other mammal species
- Excellent birdwatching, with over 350 resident species
- Including diverse geology and flora habitats
- Steeped in history, having seen the passage of Matabele King Mzilikazi, Scottish pioneer Dr David Livingstone, British engineer and artist Sir Cornwallis Harris, and renowned South African author Herman Charles Bosman
- Exceptional, FGASA-accredited field guides
- Private accommodation, looking onto the game-filled plains and towards the Dwaarsberg
- A popular family destination

### About the Lodges

**Lelapa Lodge:** Lelapa (meaning 'family' in Setswana) welcomes guests of all ages, with family-friendly accommodations and specially-planned children's activities. Each of its 12 luxury Suites has a private lounge, viewing deck, and plunge pool, with the four Family Suites also incorporating a second children's bedroom, stocked with toys and games. While the lodge, respectful of the natural environment in its construction, epitomises contemporary African design, its atmosphere is luxuriously laid-back.

**Kopano Lodge:** The modern lodge, influenced by an African design aesthetic, comprises just four luxury Suites and reminds of a traditional homestead. Kopano (meaning 'small gathering' in Setswana) can be booked out on an exclusive basis and is well-suited to a get-together of friends or family. Each Suite's private lounge, viewing deck, and plunge pool provide personal space and are ideal vantages from where to spot the wildlife coming by.

**Dithaba Lodge:** Dithaba (meaning 'mountain' in Setswana) has just four luxury Suites overlooking the expansive reserve. Each is a couple or solo traveller's retreat; or together, an exclusive home base for a friend or family group while on safari. The lodge's construction, incorporating natural design elements, is uncomplicated, and each Suite – with its own lounge, plunge pool, and viewing deck – provides space to unwind and watch the animals out on the plains.

**Elela Villa:** At Madikwe Safari Lodge, Elela Villa is a testament to luxury, named after the Setswana phrase 'to flow as water'. This exquisite three-bedroom sanctuary offers an experience akin to the gentle and persistent flow of a river. Designed to echo the fluidity and grace of water, Elela Villa marries rich heritage with unparalleled luxury. Here, in the heart of the African wilderness, guests are enveloped in an ambiance that subtly blends grandeur with intimacy, reflecting the serene flow of nature itself.

### Location

**Madikwe Safari Lodge:** is located in the central-eastern region of Madikwe Game Reserve, in South Africa's North West Province, bordering Botswana. The area surrounding the lodge is well known for its rich biodiversity, and provides some of the best game-viewing opportunities on the reserve. This, coupled with its low concentration of safari vehicles, makes for a superior wildlife experience.

**GPS co-ordinates:** should not be followed as these may get guests lost and most recommended routes are not navigable by normal vehicle.

### Weather

Average maximum temperatures range from 23°C/73°F in July to 40°C/104°F in January, with the lowest average minimum occurring in July at 2°C/36°F • The region is semi-arid, with an average annual rainfall of 500mm (20in), occurring mostly during the summer months (December – February) • Rain is usually in the form of thundershowers, where a downpour is experienced, very seldom lasting longer than a few hours

### Best Time to Travel

A year-round safari destination • The animals in Madikwe Game Reserve are non-migratory, and variation in the safari experience is season rather than location related • The best period for birdwatching is from October to April

### Health Info: Malaria

Madikwe Game Reserve is situated in a region of South Africa that is NOT inhabited by the malaria-carrying mosquito (Anopheles), and the region and reserve are therefore classified MALARIA FREE.

Lelapa Lodge Layout

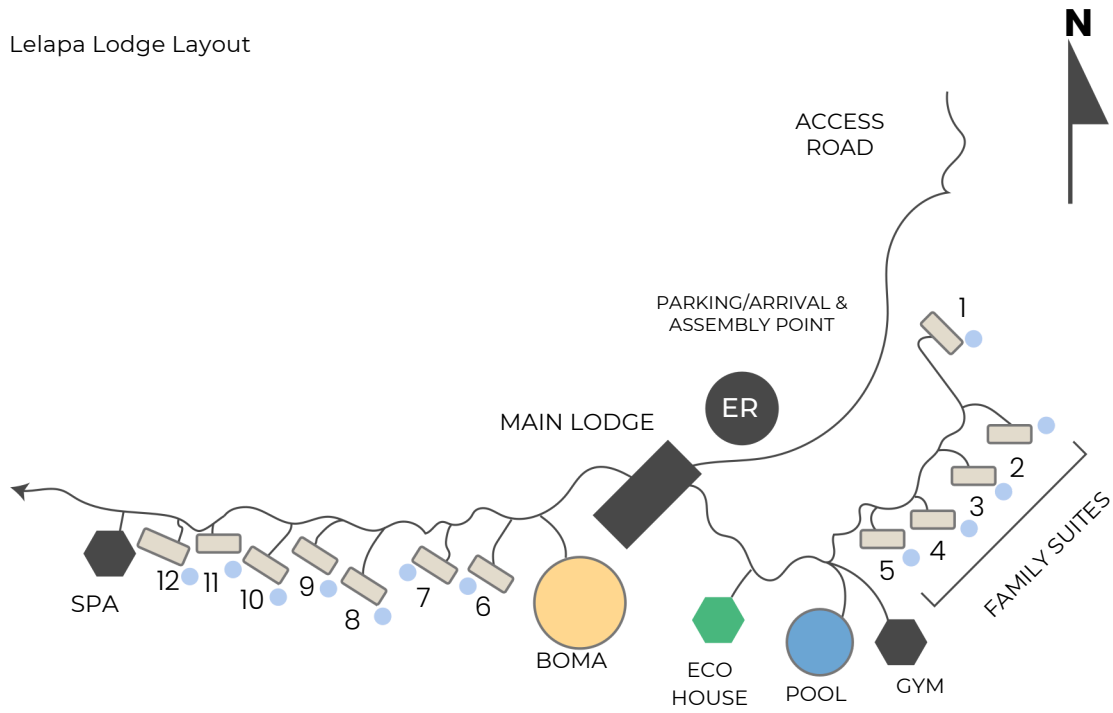

Lelapa Lodge Suite Layout

Interior - 50m<sup>2</sup> | 540ft<sup>2</sup>  
 Exterior - 50m<sup>2</sup> | 540ft<sup>2</sup>  
 Total - 100m<sup>2</sup> | 1 080ft<sup>2</sup>

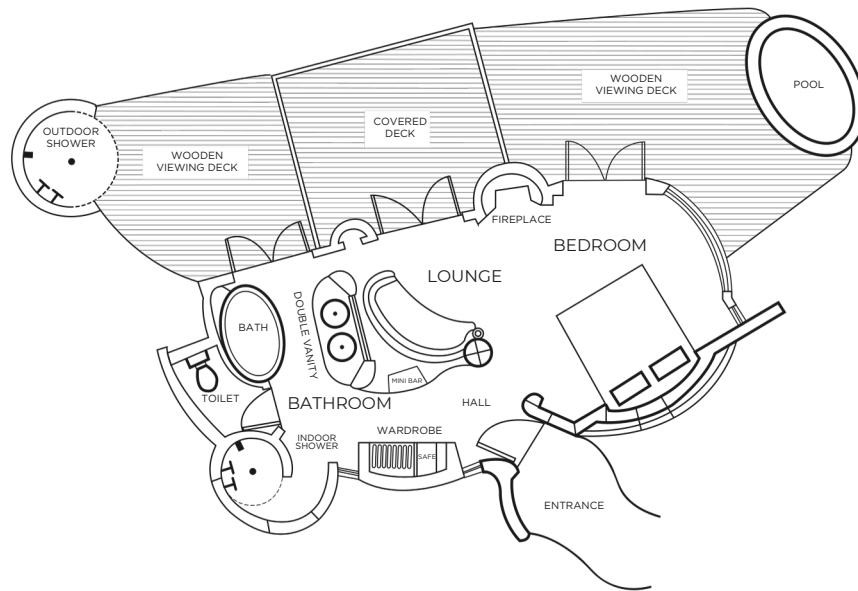

Lelapa Lodge Family Suite Layout

Interior - 50m<sup>2</sup> | 540ft<sup>2</sup>  
 Exterior - 50m<sup>2</sup> | 540ft<sup>2</sup>  
 Total - 100m<sup>2</sup> | 1 080ft<sup>2</sup>

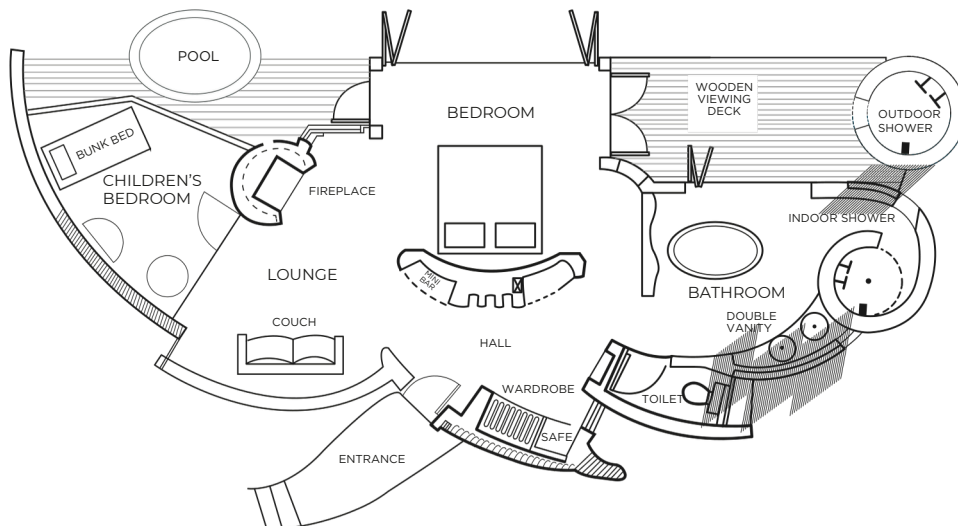

*Madikwe*  
 SAFARI LODGE

Kopano Lodge Layout

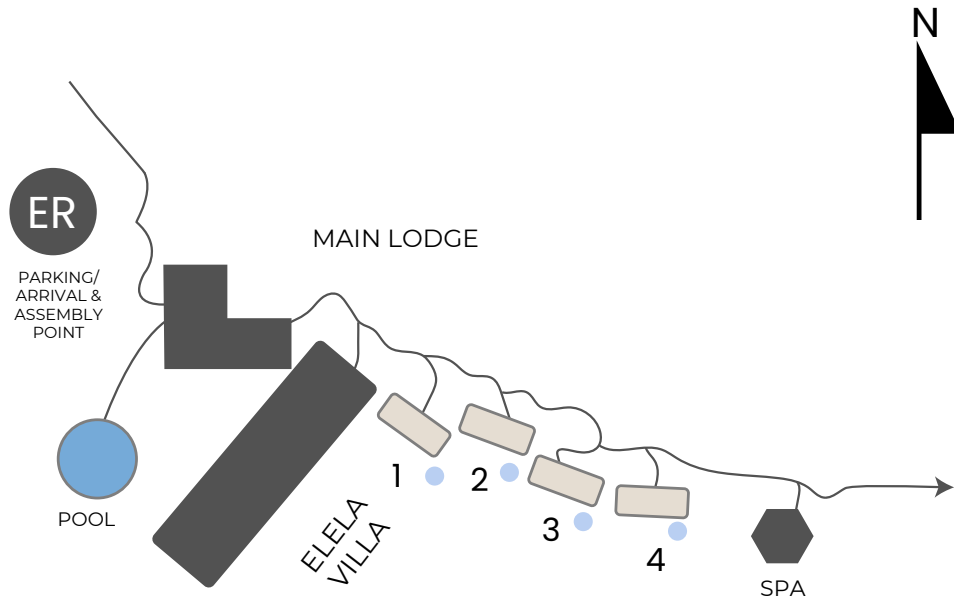

Kopano Lodge Suite Layout

Interior - 50m<sup>2</sup> | 540ft<sup>2</sup>  
 Exterior - 50m<sup>2</sup> | 540ft<sup>2</sup>  
 Total - 100m<sup>2</sup> | 1 080ft<sup>2</sup>

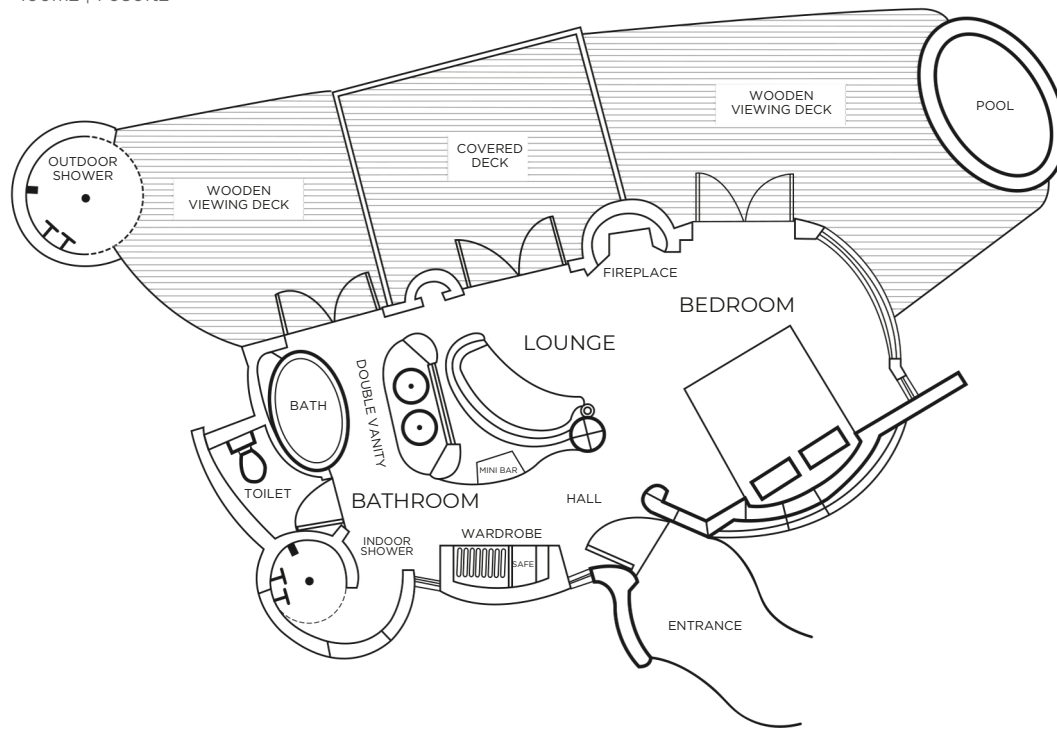

*Madikwe*  
 SAFARI LODGE

Dithaba Lodge Layout

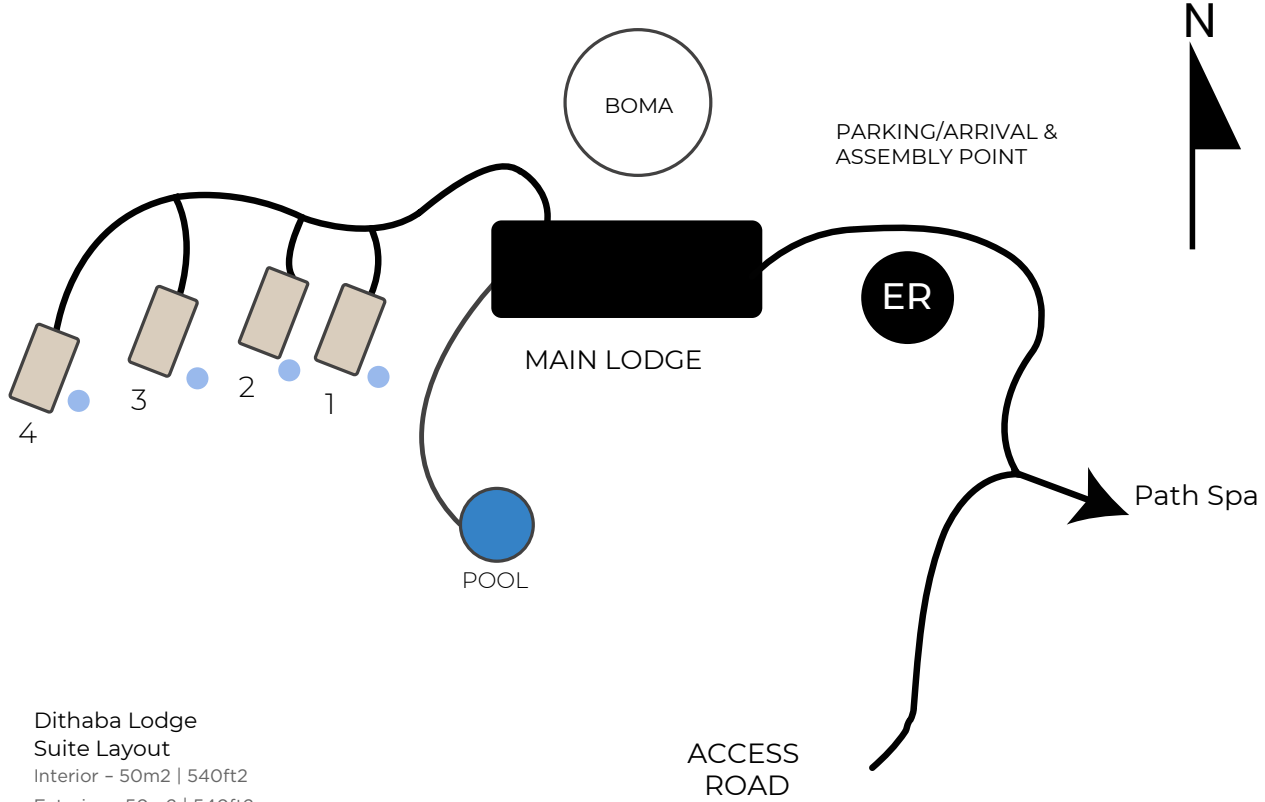

Dithaba Lodge  
Suite Layout  
Interior - 50m2 | 540ft2  
Exterior - 50m2 | 540ft2  
Total - 100m2 | 1 080ft2

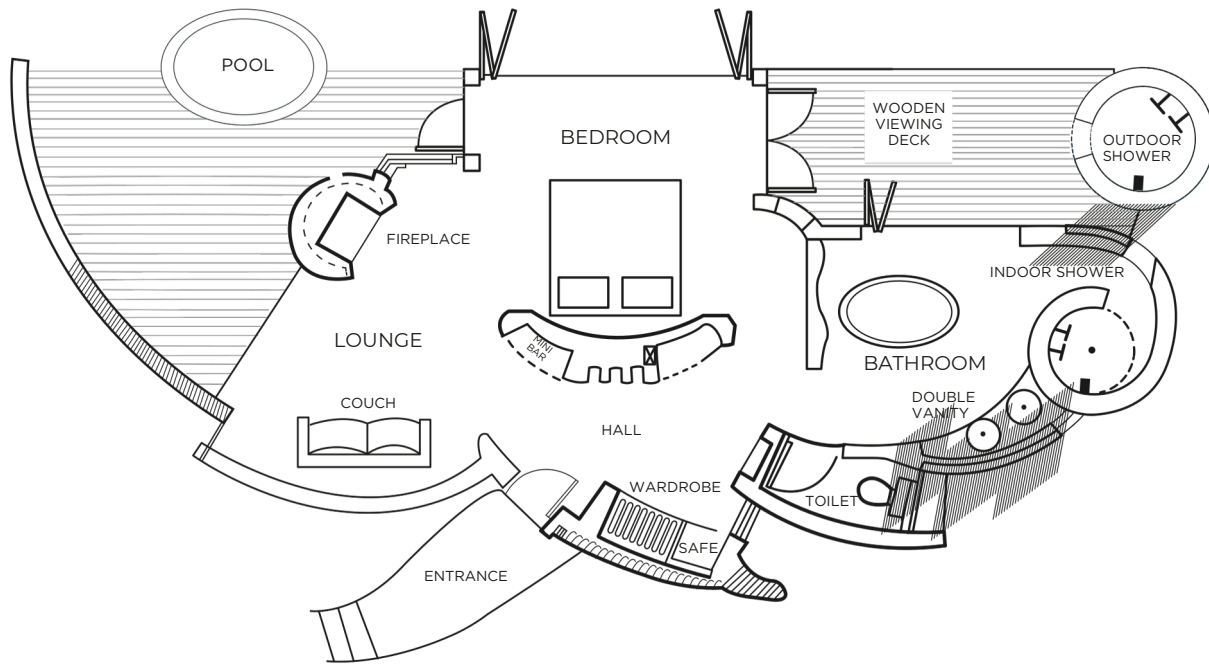

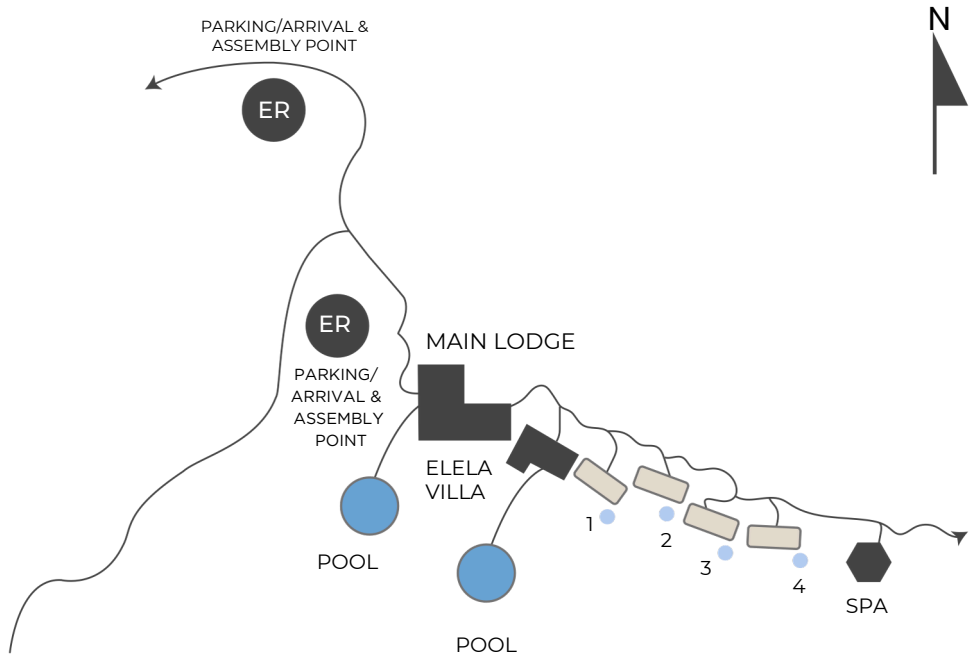

**Elela Villa Layout**  
 Interior - 50m2 | 540ft2  
 Exterior - 50m2 | 540ft2  
 Total - 100m2 | 1 080ft2

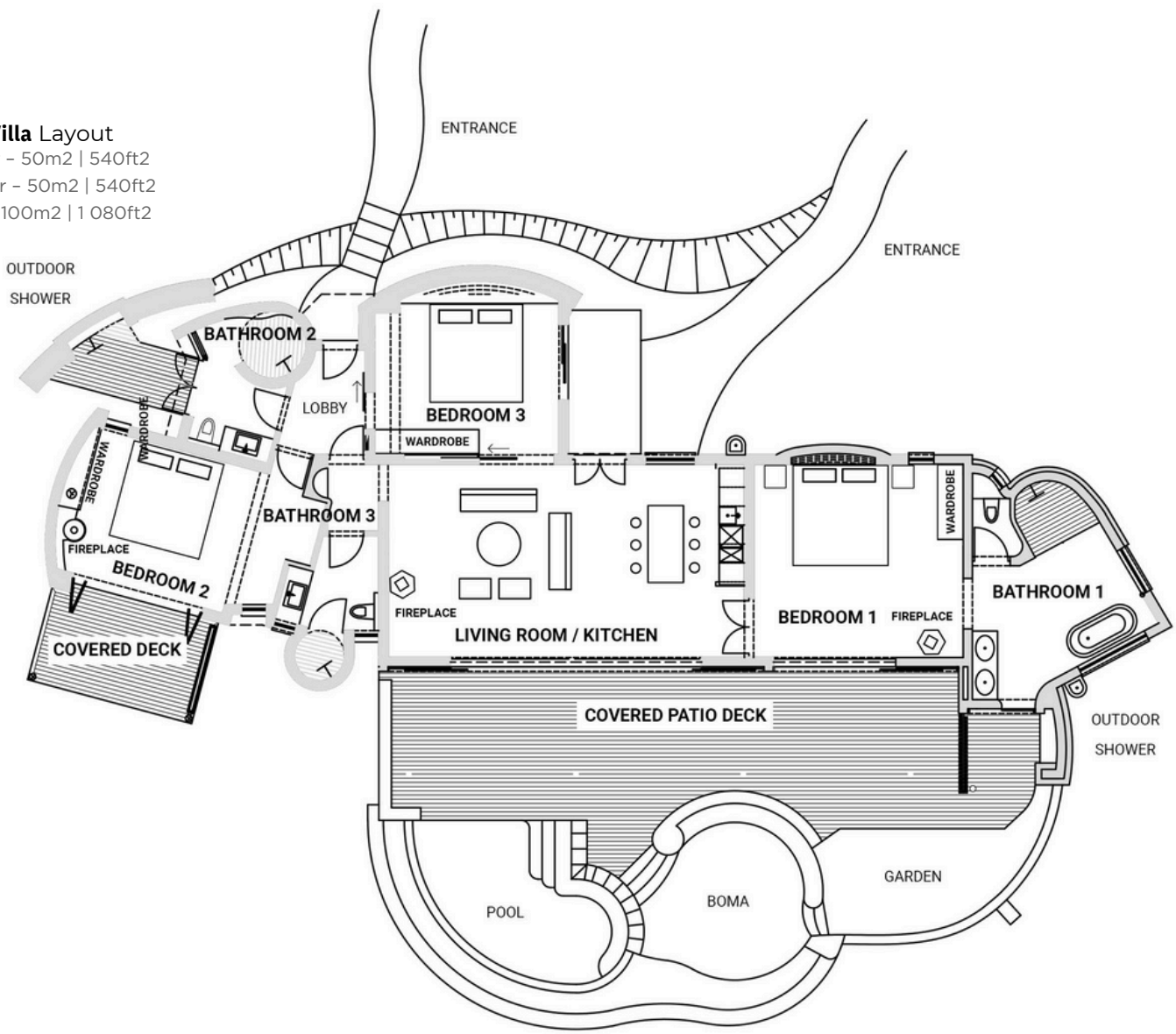

Reference Table – Lelapa Lodge, Kopano Lodge, Dithaba Lodge and Elela Villa

Reference	Lelapa Lodge	Kopano Lodge	Dithaba Lodge	Elela Villa
Suites Size	12 Suites (incl 4 Family Suites)	4 Suites	4 Suites	Bedroom Villa
of suites	Suites: 100m2/1 080ft2	100m2/1 080ft2	Suites: 100m2/1 080ft2	210m2/2260ft2
Guests	24	8	8	6
Children	Yes (all ages)	>16 (all ages if booked exclusively)	>16 (all ages if booked exclusively)	>12
Children's rate	<5 (free) 6 to 15 (50% of adult rate)	<5 (free) 6 to 15 (50% of adult rate)	<5 (free) 6 to 15 (50% of adult rate)	<5 (free) 6 to 15 (50% of adult rate)
Children on safari	Private and family game drive (all ages) Twice-daily game drive (>6)	Private and family game drive (all ages) Twice-daily game drive (>6)	Private and family game drive (all ages) Twice-daily game drive (>6)	Private game drive with private vehicle included
Children activities	Yes	No	Yes (if booked exclusively)	Yes
Childminding	Yes (additional cost)	No	Yes (additional cost)	Yes
Triple rooms (sleeper couch)	5	0	4	0
Single traveller supplement	Yes (50% supplement)	Yes (50% supplement)	Yes (50% supplement)	No
Double bed convertible to twin	Yes	Yes	Yes	Yes
Central guest pool	Yes	Yes	Yes	Yes
Private plunge pool	Yes	Yes	Yes	Yes
Air conditioning	Yes	Yes	Yes	Yes
Fireplace	Yes	Yes	Yes	Yes
Room fans	Yes	Yes	Yes	Yes
Mosquito nets	On request	On request	On request	On request
Outdoor shower	Yes	Yes	Yes	Yes
Indoor showers	Yes	Yes	Yes	Yes
Separate WC	Yes	Yes	Yes	Yes
Free Wi-Fi	Yes	Yes	Yes	Yes
Satellite television	Yes (guest area)	No	Yes (guest area)	Yes (guest area)
In-room telephone	Yes (direct dial)	Yes (direct dial)	Yes (direct dial)	Yes (direct dial)
Mobile coverage	Average: 60% (MTN/Vodacom)	Average: 60% (MTN/Vodacom)	Average: 60% (MTN/Vodacom)	Average: 60% (MTN/Vodacom)
In-room safe	Yes	Yes	Yes	Yes
Minibar	Yes	Yes	Yes	Yes
Hairdryer	Yes	Yes	Yes	Yes
Laundry	Yes (additional cost)	Yes (additional cost)	Yes (additional cost)	Yes (additional cost)
Conference facilities	Yes (but no dedicated room)	No	Yes (but no dedicated room)	Yes (but no dedicated room)
Spa facilities	Yes	Yes	Yes	Yes
Gym facilities	Private gym basket & access to gym at Lelapa	Private gym basket & access to gym at Lelapa	Private gym basket & access to gym at Lelapa	Private gym basket & access to gym at Lelapa
Suitable for disabled guests	Yes (with assistance)	Yes (with assistance)	Yes (with assistance)	Yes (with assistance)
Distance between rooms	10–15m/33–49ft	10–15m/33–49ft	10–15m/33–49ft	10–15m/33–49ft
Airstrip	Yes (15 minutes away) 24°44'0"S   26°24'25"E	Yes (15 minutes away) 24°44'0"S   26°24'25"E	Yes (15 minutes away) 24°44'0"S   26°24'25"E	Yes (15 minutes away) 24°44'0"S   26°24'25"E
Helipad	Yes (24°43'11.8"S   26°23'4.2"E)	Yes (24°43'11.8"S   26°23'4.2"E)	Yes (24°43'11.8"S   26°23'4.2"E)	Yes (24°43'11.8"S   26°23'4.2"E)
Guests per open safari vehicle	6	6	6	6
Private open safari vehicle	Yes (additional cost, subject to availability)	Yes (additional cost, subject to availability)	Yes (additional cost, subject to availability)	Yes (additional cost, subject to availability)
Languages of field rangers	English, Afrikaans	English, Afrikaans	English, Afrikaans	English, Afrikaans
Gratuity recommendation	ZAR600* per guest per day *Specific allocations clarified on request	ZAR600* per guest per day *Specific allocations clarified on request	ZAR600* per guest per day *Specific allocations clarified on request	ZAR600* per guest per day *Specific allocations clarified on request
Kosher dining	Yes (with prior notice, at an additional cost)	Yes (with prior notice, at an additional cost)	Yes (with prior notice, at an additional cost)	Yes (with prior notice, at an additional cost)
Power	220V AC	220V AC	220V AC	220V AC
Credit cards	Mastercard, Visa, Amex	Mastercard, Visa, Amex	Mastercard, Visa, Amex	Mastercard, Visa, Amex
Cheques	Not accepted	Not accepted	Not accepted	Not accepted