

DITHABA LODGE - FACT SHEET

Dithaba Lodge & The Reserve Pg1 | Architectural Layouts Pg2 | Reference Table Pg3

Dithaba Lodge | Tel: +27 (0)18 350 9902 | Email: res@madikwesafarilodge.co.za

About the Lodges

Madikwe Safari Lodge's Dithaba Lodge is ideally located for guests to appreciate the vastness and diversity of Madikwe Game Reserve's landscapes and wildlife. Dithaba (meaning 'mountain' in Setswana) has just 4 luxury Suites overlooking the expansive reserve. Each is a couple or solo traveller's retreat; or together, an exclusive home base for a friend or family group while on safari. The lodge's construction, incorporating natural design elements, is uncomplicated, and each Suite - with its own lounge, plunge pool, and viewing deck - provides space to unwind and watch animals cross the plain.

Lodge Features

- **Main lodge lounge and dining deck, with a fireplace**
- **Star Deck for an al fresco dining experience that is out of this world**
- **Boma, hosting fireside diners under the stars**
- **Indoor lounge and dining room, each with a fireplace**
- **Kosher dining offering to ensure our Jewish guests can enjoy every treat a stay here has to offer**
- **Access to Lelapa Lodge's guest pool, positioned just up a waterhole for an incredible 'poolside safari'**
- **In-room spa and beauty treatments at the hands of expert therapists**
- **Complimentary Wi-Fi - but we recommend a digital detox**
- **Madikwe Safari Lodge Gallery (at Lelapa Lodge), retailing rare and beautiful keepsakes, as well as everyday essentials**

Location

Dithaba Lodge, Madikwe Safari Lodge is located in the central-eastern region of Madikwe Game Reserve. The area surrounding the lodge is well known for its rich biodiversity and provides some of the best game-viewing opportunities on the reserve.

GPS co-ordinates: should not be followed as these may get guests lost and most recommended routes are not navigable by normal vehicle.

Weather

Average maximum temperatures range from 23°C/73°F in July to 40°C/104°F in January, with the lowest average minimum occurring in July at 2°C/36°F • The region is semi-arid, with an average annual rainfall of 500mm (20in), occurring mostly during the summer months (December - February) • Rain is usually in the form of thundershowers, where a downpour is experienced, very seldom lasting longer than a few hours

Best Time to Travel

A year-round safari destination • The animals in Madikwe Game Reserve are non-migratory, and variation in the safari experience is season rather than location related • The best period for birdwatching is from October to April

Health Info: Malaria

Dithaba Lodge, Madikwe Safari Lodge is situated in a region of South Africa that is not inhabited by the malaria-carrying mosquito (Anopheles) and is therefore classified MALARIA FREE.

Dithaba Lodge Layout

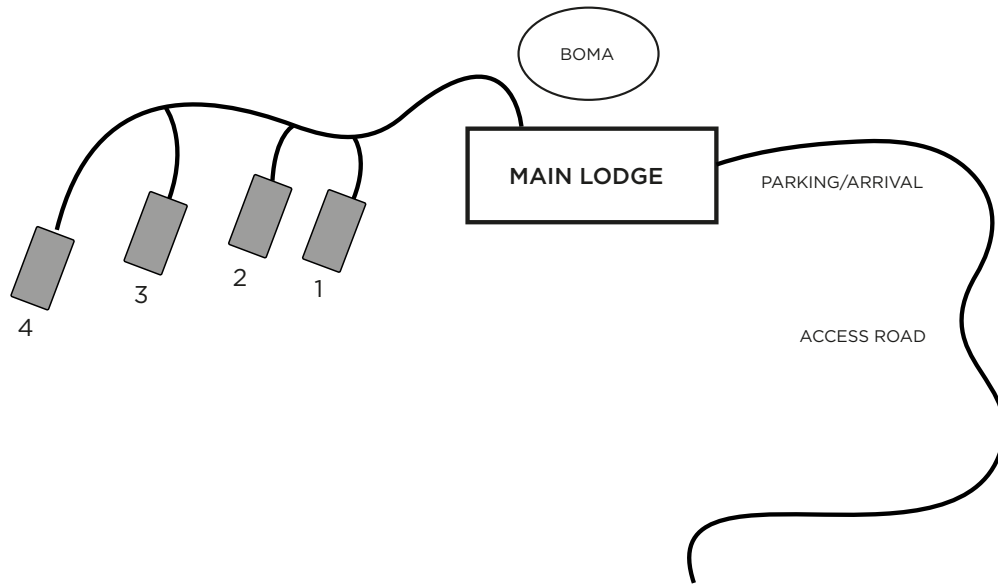

Dithaba Lodge Suite Layout

Interior - 50m² | 540ft²

Exterior - 50m² | 540ft²

Total - 100m² | 1 080ft²

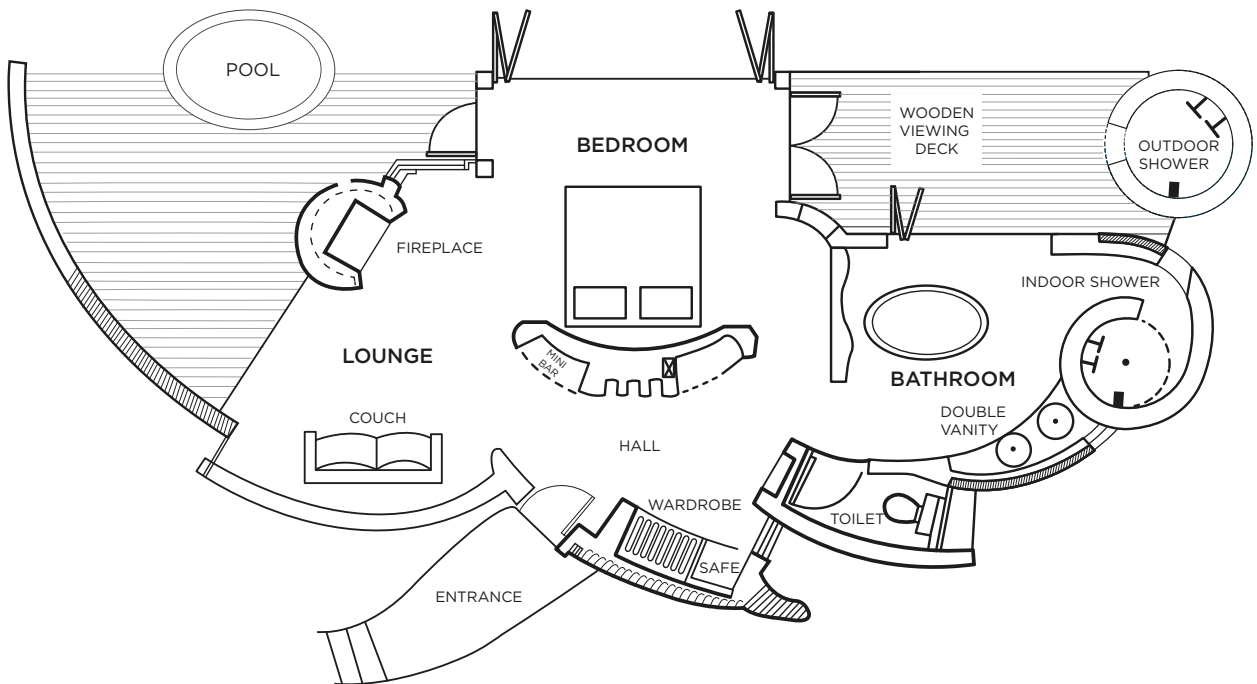

Reference Table - Dithaba Lodge

Reference	Dithaba Lodge
Suites	4 Suites
Size of suites	100m ² /1 080ft ²
Guests	8
Children	>16 (all ages if booked exclusively)
Children's rate	<5 (free) 6 to 15 (50% of adult rate)
Children on safari	Private and family game drive (all ages) Twice-daily game drive (>6)
Children activities	Yes (if booked exclusively)
Childminding	Yes (additional cost)
Triple rooms (sleeper couch)	4
Single traveller supplement	Yes (50% supplement)
Double bed convertible to twin	Yes
Central guest pool	No
Private plunge pool	Yes
Air conditioning	Yes
Fireplace	Yes
Room fans	Yes
Mosquito nets	Yes
Outdoor shower	Yes
Indoor showers	Yes
Separate WC	Yes
Free Wi-Fi	Yes
Satellite television	Yes (guest area)
In-room telephone	Yes (direct dial)
Mobile coverage	Average: 60% (MTN/Vodacom)
In-room safe	Yes
Minibar	Yes
Hairdryer	Yes
Laundry	Yes (additional cost)
Conference facilities	Yes (but no dedicated room)
Spa facilities	In-room treatments (additional cost)
Gym facilities	Yes - 'Gym in a Basket' (with a yoga mat, weights, resistance bands, and jump rope)
Suitable for disabled guests	No
Distance between rooms	10-15m/33-49ft
Airstrip	Yes (15 minutes away) 24°44'0"S 26°24'25"E
Helipad	Yes (24°43'11.8"S 26°23'4.2"E)
Guests per open safari vehicle	6
Private open safari vehicle	Yes (additional cost, subject to availability)
Languages of field rangers	English, Afrikaans
Gratuuity recommendation	ZAR600* per guest per day *Specific allocations clarified on request
Kosher dining	Yes (with prior notice, at an additional cost)
Power	220V AC
Credit cards	Mastercard, Visa, Amex
Cheques	Not accepted